



# IPTESTBOX

Portable vacuum and pressure tester with  
air compressor for Prolights IP fixtures



---

## USER MANUAL

---

## ***Thank you for choosing PROLIGHTS***

Please note that every PROLIGHTS product has been designed in Italy to meet quality and performance requirements for professionals and designed and manufactured for the use and application as shown in this document.

Any other use, if not expressly indicated, could compromise the good condition/operation of the product and/or be a source of danger.

This product is meant for professional use. Therefore, commercial use of this equipment is subject to the respectively applicable national accident prevention rules and regulations.

Features, specifications and appearance are subject to change without notice. Music & Lights S.r.l. and all affiliated companies disclaim liability for any injury, damage, direct or indirect loss, consequential or economic loss or any other loss occasioned by the use of, inability to use or reliance on the information contained in this document.

Product user manual can be downloaded from the website [www.prolights.it](http://www.prolights.it), or can be inquired to the official PROLIGHTS distributors of your territory ([https://www.prolights.it/sales\\_network.html](https://www.prolights.it/sales_network.html)).

Scanning the below **QR Code**, you will access the download area of the product page, where you can find a broad set of always updated technical documentation: specifications, user manual, technical drawings, photometrics, personalities, fixture firmware updates.



**Visit the download area  
of the product page**



The PROLIGHTS Logo, PROLIGHTS names and all other trademark in this document pertaining to PROLIGHTS services or PROLIGHTS product are trademarks OWNED or licensed by Music & Lights S.r.l., its affiliates, and subsidiaries. PROLIGHTS is a registered trademark by Music & Lights S.r.l. All right reserved. Music & Lights – Via A. Olivetti, snc - 04026 - Minturno (LT) ITALY.

# INDEX

<b>SAFETY INFORMATION</b>	<b>02</b>
<b>1 - PACKAGING</b>	<b>04</b>
PACKAGE CONTENT .....	04
OPTIONAL ACCESSORIES.....	04
<b>2 - TECHNICAL DRAWING</b>	<b>04</b>
<b>3 - PRODUCT OVERVIEW</b>	<b>05</b>
<b>4 - CONNECTION TO THE MAINS SUPPLY</b>	<b>06</b>
<b>5 - START UP</b>	<b>06</b>
CONNECT AND DISCONNECT POWER FROM THE PRODUCT.....	06
<b>6 - CONTROL PANEL</b>	<b>07</b>
DISPLAY AND BUTTONS LAYOUT .....	07
<b>7 - MENU STRUCTURE</b>	<b>08</b>
<b>8 - USE</b>	<b>09</b>
<b>9 - FIRMWARE UPDATE</b>	<b>11</b>
<b>10 - MAINTENANCE</b>	<b>12</b>
MAINTENANCE THE PRODUCT .....	12
VISUAL CHECK OF PRODUCT HOUSING .....	12
TROUBLESHOOTING.....	12

# SAFETY INFORMATION



## WARNING!

- See <https://www.prolights.it/product/IPTESTBOX#download> for installation instructions.
- Please read carefully the instruction reported in this section before installing, powering, operating or servicing the product and observe the indications also for its future handling.



**This unit is not for household and residential use, only professional applications.**



## Connection to mains supply

- The Connection to the mains supply must be carried out by a qualified electrical installer.
- Use only AC supplies 100-240V 50-60 Hz, the fixture must be electrically connected to ground (earth).
- Select the cable cross section in according with the maximum current draw of the product and the possible number of products connected at the same power line.
- The AC mains power distribution circuit must be equipped with magnetic+residual current circuit breaker protection.
- Do not connect it to a dimmer system; doing so may damage the product.



## Protection and Warning against electrical shock

- Do not remove any cover from the product, always disconnect the product from AC power before servicing.
- Ensure that the fixture is electrically connected to ground (earth). And use only a source of AC power that complies with local building and electrical codes and has both overload and ground-fault (earth-fault) protection.
- Before using the fixture, check that all power distribution equipment and cables are in perfect condition and rated for the current requirements of all connected devices.
- Isolate the fixture from power immediately if the power plug or any seal, cover, cable, or other components are damaged, defective, deformed or showing signs of overheating.
- Do not reapply power until repairs have been completed.
- Refer any service operation not described in this manual to PROLIGHTS Service team or an authorized PROLIGHTS service center.



## Installation

- Make sure that all visible parts of the product are in good visible condition before its use or installation.
- Make sure the point of anchorage is stable before positioning the device.
- Install the product only in well ventilated places.
- For non temporary installations, ensure that the fixture is securely fastened to a load-bearing surface with suitable corrosionresistant hardware.
- Do not install the fixture near sources of heat.
- If this device will be operated in any way different to the one described in this manual, it may suffer damages and the guarantee becomes void. Furthermore, any other operation may lead to dangers like short circuit, burns, electric shock, etc

**T<sub>a</sub>45°C**

## Max operating ambient temperature (T<sub>a</sub>)

- Do not operate the fixture if the ambient temperature (T<sub>a</sub>) exceeds 45 °C (113 °F).

**T<sub>a</sub>-10°C**

## Minimum operating ambient temperature (T<sub>a</sub>)

- Do not operate the fixture if the ambient temperature (T<sub>a</sub>) is below -10 °C (14 °F).



### Protection from burns and fire

- The exterior of the fixture becomes hot during use. Avoid contact by persons and materials.
- Ensure that there is free and unobstructed airflow around the fixture.
- Keep flammable materials well away from the fixture
- Do not expose the front glass to sunlight or any other strong light source from any angle. Lenses can focus the sun's rays inside the fixture, creating a potential fire hazard.
- Do not attempt to bypass thermostatic switches or fuses.



### Indoor use

- This product is designed for indoor and dry environments.
- Do not use in wet location and do not expose the fixture to rain or moisture.
- Never use the fixture in places subject to vibrations or bumps.
- Make certain that no inflammable liquids, water or metal objects enter the fixture.
- Excessive dust, smoke fluid, and particle build up degrades performance, causes overheating and will damage the fixture.
- Damages caused by inadequate cleaning or maintenance are not covered by the product warranty.



### Maintenance

- Warning! Before starting any maintenance work or cleaning of the unit, disconnect the fixture from AC mains power and allow to cool for at least 10 minutes before handling.
- Only technicians who are authorized by PROLIGHTS or Authorised service partners are permitted to open the fixture.
- Users may carry out external cleaning, following the warnings and instructions provided, but any service operation not described in this manual must be referred to a qualified service technician.
- Important! Excessive dust, smoke fluid, and particle build up degrades performance, causes overheating and will damage the fixture. Damages caused by inadequate cleaning or maintenance is not covered by the product warranty.



### Disposal

- This product is supplied in compliance with European Directive 2012/19/EU – Waste Electrical and Electronic Equipment (WEEE). To preserve the environment please dispose/ recycle this product at the end of its life according to the local regulation.



### The products to which this manual refers comply with:

- 2014/35/EU - Safety of electrical equipment supplied at low voltage (LVD).
- 2014/30/EU - Electromagnetic Compatibility (EMC).
- 2011/65/EU - Restriction of the use of certain hazardous substances (RoHS).



### Other approvals



# 1 - PACKAGING

## PACKAGE CONTENT

- 1 x IPTESTBOX
- 1 x Flexible Tube
- 1 x M12 Thread Adapter
- 1 x Cap with M12 Thread
- User Manual

## OPTIONAL ACCESSORIES

- IPTBM6ADP: M6 Adapter and M6 cap for IPTESTBOX;
- 958225L03: 3x2.5mm TH07 Cable, 16A 3p PwCon MXW, 16A 3p PwCon FXW, L. 3m;
- 9513FXWL03: Ass. 3x2.5mm TH07 Cable, 16A 3p 230V CEE Plug, MENAC3FXW Socket, L. 3m;
- 9533FXWL03: Ass. 3x2.5mm TH07 Cable, SCHUKO Plug, MENAC3FXW Socket, L. 3m.

# 2 - TECHNICAL DRAWING

---

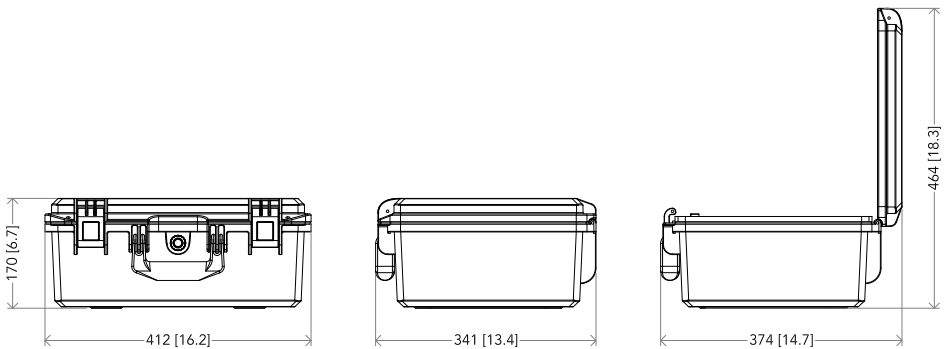

Fig. 01

### 3 - PRODUCT OVERVIEW

1. VACUUM PORT;
2. USER INTERFACE with display and buttons for access to the control panel functions;
3. Micro SD port;
4. USB port;
5. ON-OFF switch;
6. POWER IN: for connection to the Mains 100-240V~/50-60Hz;
7. MAIN FUSE HOLDER: replace a burnt-out fuse by one of the same type only (T2A 250V).

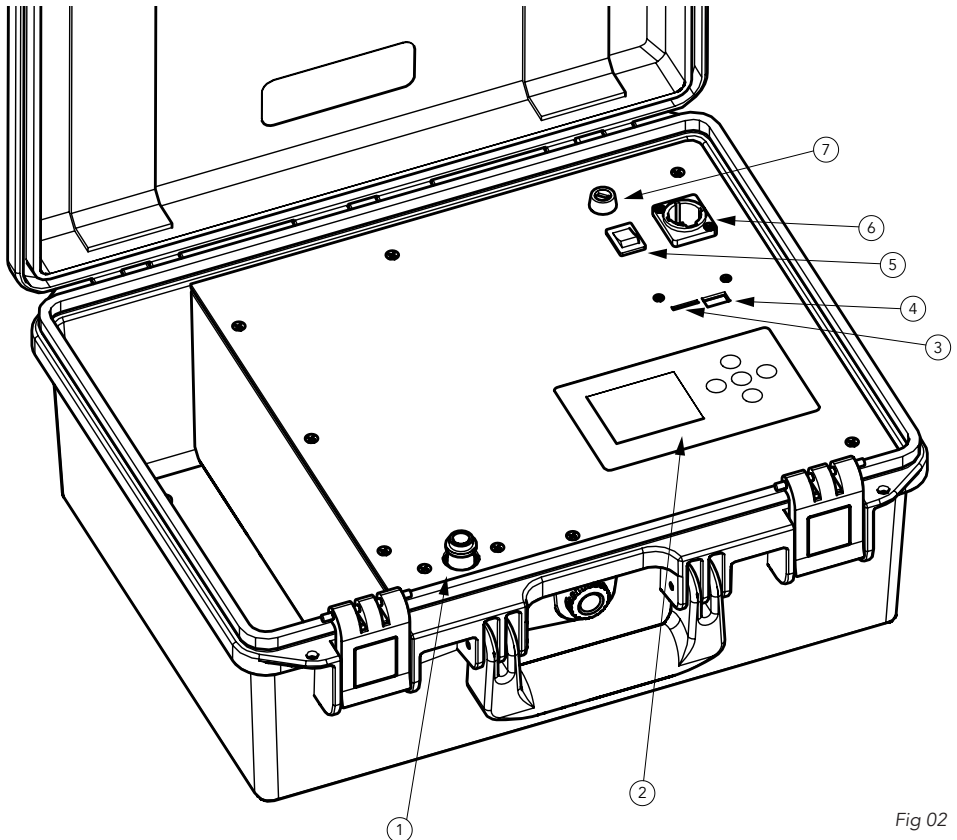

Fig 02

## 4 - CONNECTION TO THE MAINS SUPPLY

**WARNING:** For protection from electric shock, the fixture must be earthed!

The product is equipped with auto-switching power supply that automatically adjusts to any 50-60Hz AC power source from 100-240 Volts (max absolute range : 90- 264V).

If you need to install a power plug on the power cable to allow connection to power outlets, install a grounding-type (earthed) plug, following the plug manufacturer's instructions. If you have any doubts about proper installation, consult a qualified electrician.

The max power consumption is 40W.

Core (EU)	Core (US)	Connection	Plug terminal marking
Brown	Black	Live	L
Blue	White	Neutral	N
Yellow+green	Green	Earth	

## 5 - START UP

### CONNECT AND DISCONNECT POWER FROM THE PRODUCT

To apply and disconnect power to the product:

- Check that the product is installed and secured as indicated in the Safety Informations, and that personal safety will not be put at risk when the fixture lights up.
- Connect the power connector into the Mains input socket (100-240 VAC-50/60 Hz).
- The product is then ready for its operations and can be controlled through the available input signals on board.
- To disconnect power from the product, disconnect the Mains from the socket.



# 6 - CONTROL PANEL

The product has an OLED display and 5 buttons for access to the functions of the control panel.

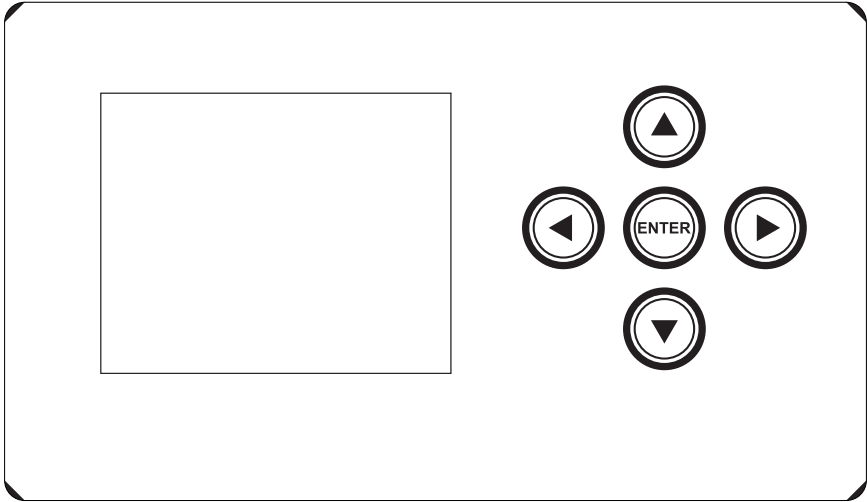







Fig. 03

## DISPLAY AND BUTTONS LAYOUT

The product has a display and buttons for access to the control panel functions:

	<ul style="list-style-type: none"><li>• UP: To scroll through the functions of the main menu or increase the value of the function.</li></ul>
	<ul style="list-style-type: none"><li>• DOWN: To scroll through the functions of the main menu or decrease the value of the function.</li></ul>
	<ul style="list-style-type: none"><li>• LEFT: To move left in the function.</li></ul>
	<ul style="list-style-type: none"><li>• RIGHT: To move right in the function.</li></ul>
	<ul style="list-style-type: none"><li>• ENTER: To enter the next menu or confirm the displayed value or to activate the function displayed.</li></ul>

# 7 - MENU STRUCTURE

The following chart describes the MENU tree of the product.

	MENU	LEVEL 1	LEVEL 2	LEVEL 3	DESCRIPTION	
1	TEST	IP65	PRESSURE VACUUM PRESSURE AND VACUUM		Select IP grade of your device, then choose the type of test.	
		IP66	PRESSURE VACUUM PRESSURE AND VACUUM			
		IP67	PRESSURE VACUUM PRESSURE AND VACUUM			
		IP68	VACUUM PRESSURE PRESSURE AND VACUUM			
2	SETUP	SCREEN	BACKLIGHT	ON	Select the timing after that display will switch automatically off when unactive.	
				10s		
				20s		
				30s		
			FLIP DISPLAY	ON	Allows you to rotate the display by 180°.	
				OFF		
			DISPLAY LOCK	ON	Allows you lock the buttons on the control panel by a password.	
				OFF		
			TEMPERATURE UNIT	°C	To choose temperature unit.	
				°F		
			PRESSURE UNIT	PSI	To choose pressure unit.	
				KPA		
3	INFORMATIONS	TEMPERATURE			To see the unit temperature.	
		KPA/PSI VALUE			To see the unit pressure.	
		FIXTURE TIME	FIXTURE HOURS	TOTAL	To check the total working hours of the unit.	
				PARTIAL		
			CURRENT HOURS	TOTAL	To check the total working hours of the unit.	
				PARTIAL		
			MAINTENANCE TIME	ELAPSED TIME		To choose and reset unit maintenance warning hours
				ALERT PERIOD	10-300	
		ERROR MESSAGE			To see any error messages.	
		DEVICE INFO				
DEVICE LABEL						
FIRMWARE VERSION			View informations about software version.			
4	DEFAULT	BASIC RELOAD	PASSWORD 050	Basic reload wipes all user settings (SD card isn't wiped)		
		ALL RELOAD	(Service use)			

## 8 - USE

IPTSTBOX is a portable tool coming into an ABS case that is capable to test IP rating for multiple PROLIGHTS products. The tool features both vacuum (aspire the air) and pressure (blow the air) test of the lighting fixtures through the internal air compressor, monitoring the pressure behaviour inside the unit housing according to the IP class of the product.

1

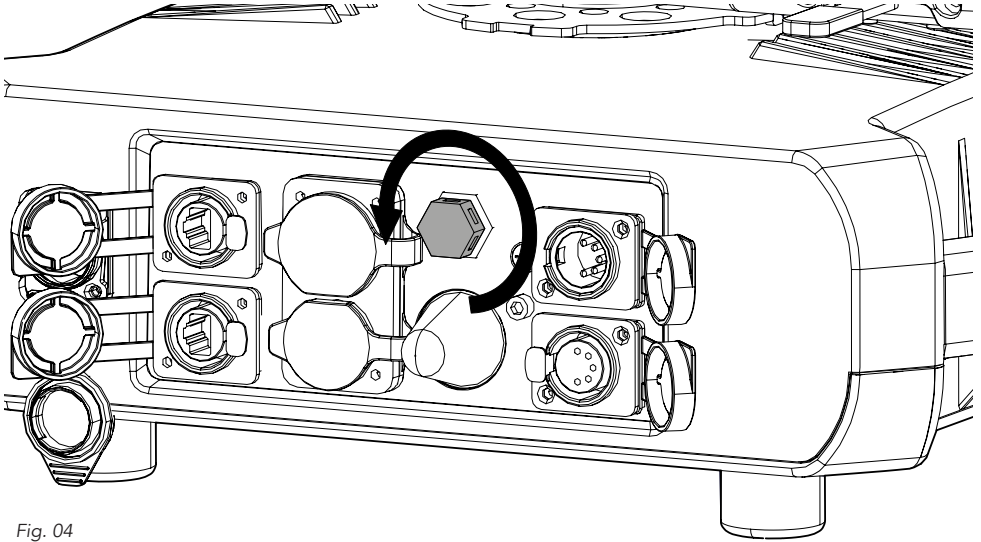

Fig. 04

Remove the gore valve from PROLIGHTS IP Product.

2

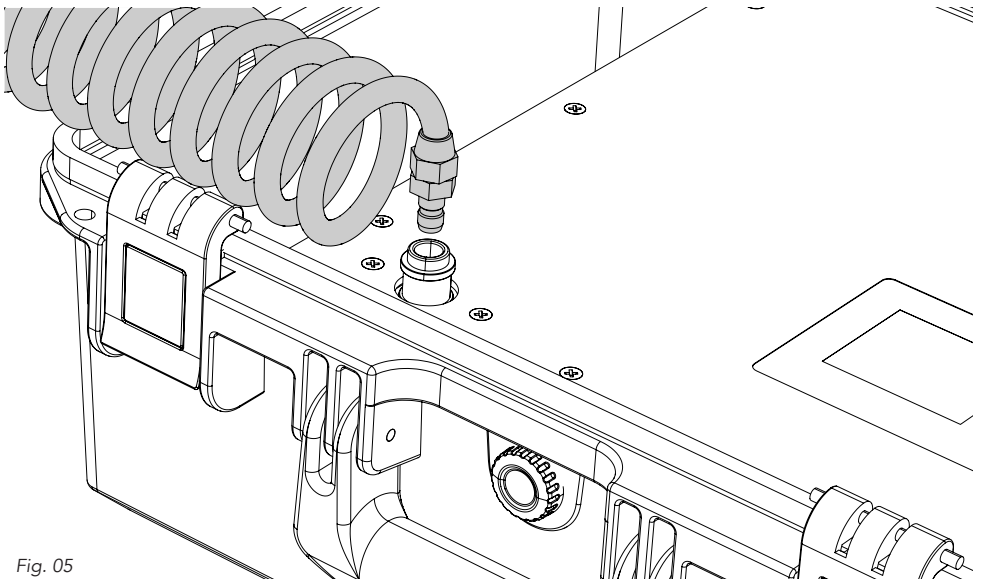

Fig. 05

Connect the air hose to the IPTSTBOX by inserting the quick-connect fitting into the coupler.

3

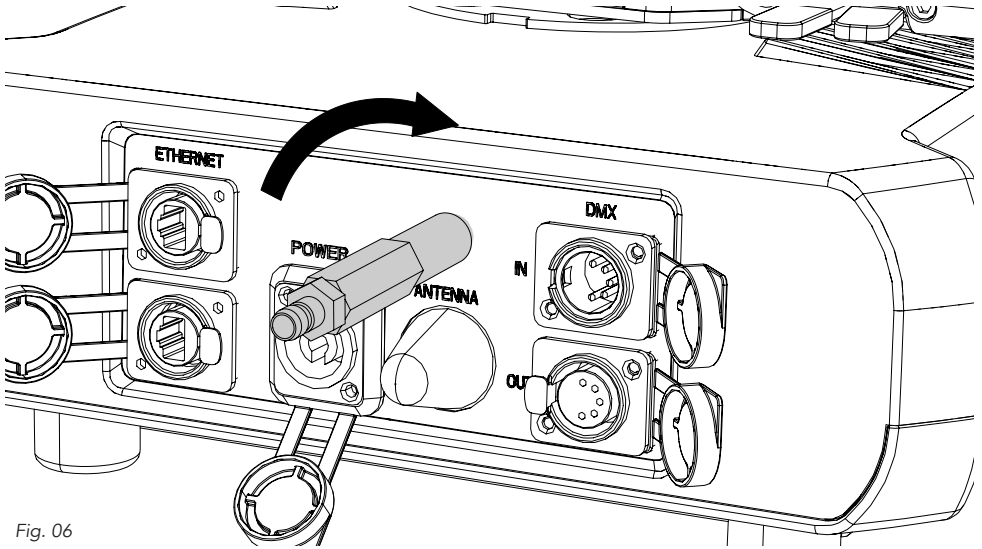

Fig. 06

Insert the Adapter into the GORE Valve hole.

**NOTE:** Check the right adapter for your PROLIGHTS IP Product

4

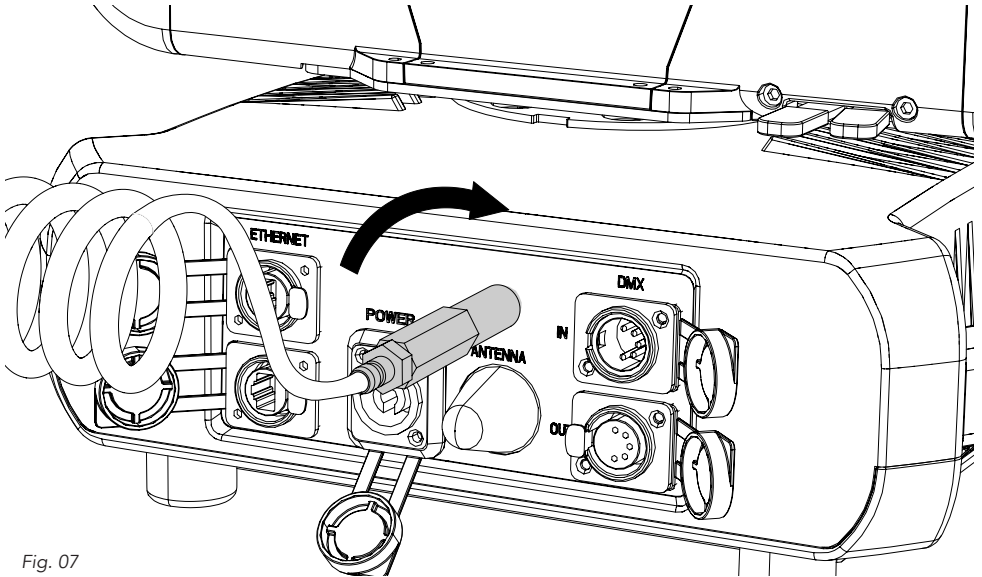

Fig. 07

Connect the air hose to the adapter.

5

Start IP test choosing IP grade of the Product.

## 9 - FIRMWARE UPDATE

1. Download latest firmware version here: <https://www.prolights.it/product/IPTESTBOX#download>.
2. Create a folder named "firmware" into a FAT32 MicroSD and copy the file in this folder.  
*NOTE: if your MicroSD is bigger than 32GB you need to create a smaller partition to format it in FAT32.*
3. Insert the MicroSD in the appropriate slot (fig.02, page 05)
4. Turn on the power switch holding ENTER+UP buttons to start IPTESTBOX in BootLoader page.
5. Press ENTER on the file that appears and wait for the operation to complete.
6. Turn off IPTESTBOX and remove MicroSD, then start the product normally.

# 10 - MAINTENANCE

## MAINTENANCE THE PRODUCT

It is recommended that the product be checked at regular intervals.

- For cleaning use a soft, clean cloth moistened with a mild detergent. Never use a liquid, it might penetrate the unit and cause damage to it.
- The user may also upload firmware (product software) to the fixture via the DMX signal input port and instructions from PROLIGHTS.
- It is recommended to check at least annually if new firmware is available and a visual check of the status of the device and mechanical parts.

**WARNING:** the use of alcohol or any other detergent could damage the lenses.

- All other service operations on the product must be carried out by PROLIGHTS, its approved service agents or trained and qualified personnel.
- It is PROLIGHTS policy to apply use the best quality materials available to ensure optimum performance and the longest possible component lifetimes. However, components are subject to wear and tear over the life of the product. The extent of wear and tear depends heavily on operating conditions and environment, so it is impossible to specify precisely whether and to what extent performance will be affected. However, you may eventually need to replace components if their characteristics are affected by wear and tear after an extended period of use.
- Use only accessories approved by PROLIGHTS.

## VISUAL CHECK OF PRODUCT HOUSING

- The parts of the product cover/housing should be checked for eventual damages and breaking start at least every two months. If hint of a crack is found on some plastic part, do not use the product until the damaged part will be replaced.
- Cracks or another damages of the cover/housing parts can be caused by the product transportation or manipulation and also ageing process may influence materials.

## TROUBLESHOOTING

Problems	Possible causes	Checks and remedies
Product doesn't power ON	• No power to the product	• Check if the battery charges possibly charge it.
	• Internal fault	• Contact the PROLIGHTS Service or authorized service partner. Do not remove parts and/or covers, or carry out any repairs or service that are not described in this Safety and User Manual unless you have both authorization from PROLIGHTS and the service documentation.

Contact an authorized service center in case of technical problems or not reported in the table can not be resolved by the procedure given in the table.















**PROLIGHTS** is a trademark of  
**MUSIC & LIGHTS S.r.l.**  
**musiclights.it**

Via A.Olivetti snc  
04026 - Minturno (LT) ITALY  
Tel: +39 0771 72190

**prolights.it**  
support@prolights.it