

| No | P/N        | DESCRIPTION                               | QTY. |
|----|------------|---|------|
| 1  | 1518-0001  | BASE PLT                                  | 1    |
| 2  | 1518-0005  | LEAN BRKT                                 | 1    |
| 3  | 1518-0009  | PHONE BRKT                                | 1    |
| 4  | 1518-0013  | STIFFENER BRKT                            | 2    |
| 5  | 1518-0021  | PHONE HOLDER TOP                          | 1    |
| 6  | 1518-0055  | EXTR LFT 482mm                            | 1    |
| 7  | 1518-0059  | EXTR TOP 28" 716mm                        | 1    |
| 8  | 1518-0063  | EXTR RGT 482mm                            | 1    |
| 9  | 1518-0103  | PCB FIL DISPLAY                           | 1    |
| 10 | 1518-0104  | PCB FIL ENGN_LFT                          | 1    |
| 11 | 1518-0105  | PCB FIL ENGN TOP_RGT                      | 1    |
| 12 | 1518-0106  | PCB FIL ENGN_RGT                          | 1    |
| 13 | 1518-0107  | PCB FIL ENGN TOP_LFT                      | 1    |
| 14 | 1518-0201  | PCB COM PROC FRAME                        | 1    |
| 15 | 1518-0302  | HARN CON_CON PROC_TO_ENGN 100MM           | 1    |
| 16 | 1518-0601  | DIFFUSER 482 LFT                          | 1    |
| 17 | 1518-0602  | DIFFUSER 716 TOP                          | 1    |
| 18 | 1518-0603  | DIFFUSER 482 RGT                          | 1    |
| 19 | 1518-0608  | GASKET 6.5X3.5                            | 2    |
| 20 | 1518-0609  | OVERLAY LFT                               | 1    |
| 21 | 1518-0610  | OVERLAY RGT                               | 1    |
| 22 | 1518-0611  | FOAM PHONE BRKT TOP                       | 4    |
| 23 | 1518-0612  | REFLECTIVE TAPE 36MM                      | 1    |
| 24 | 1518-0613  | REFLECTIVE TAPE 36MM                      | 1    |
| 25 | 1518-0616  | FOAM PHONE BRKT TOP                       | 1    |
| 26 | 318-5375-8 | FLAT TOP RECESSED BUMPER, RBM-0718-01     | 6    |
| 27 | 429-6113-9 | SCREW SELF TAP FH PZDV BLK ST2.9x13 RoHS  | 4    |
| 28 | 429-6210-0 | SCREW SELF TAP PH PLPS BLK ST2.9x9.5 RoHS | 16   |
| 29 | 430-1206-0 | SCREW, M3x6 PH PLPS BLK                   | 7    |
| 30 | 430-4125-1 | STDOFF M-F M3x25x7, 6mm STUD              | 1    |
| 31 | 430-4110-1 | STDOFF M-F M3x10x7, 6mm STUD              | 1    |
| 32 | 432-6216-3 | 3.2X16MM SNAP ON FASTENER                 | 2    |
| 33 | 440-3204-1 | NUT HEX M4 COMBI                          | 4    |
| 34 | 440-3509-0 | NUT WING M4 BLK Zn                        | 3    |
| 35 | 1915-0022  | USB C CABLE 5A 100W 5FT                   | 1    |
| 36 | 1922-0034  | ENC KNOB VISTA3 SMALL                     | 2    |
| 37 | 1925-0003  | PSU USBC 20V 4.5A 90W CHARGER             | 1    |
| 39 | 900-2174   | HIROSE BRIDGE (FLOATING PLUG) 3PIN        | 1    |
| 40 | 1914-0030  | CONN SSL BRIDGE 4POS 2MM DF59-4P-2FC      | 2    |

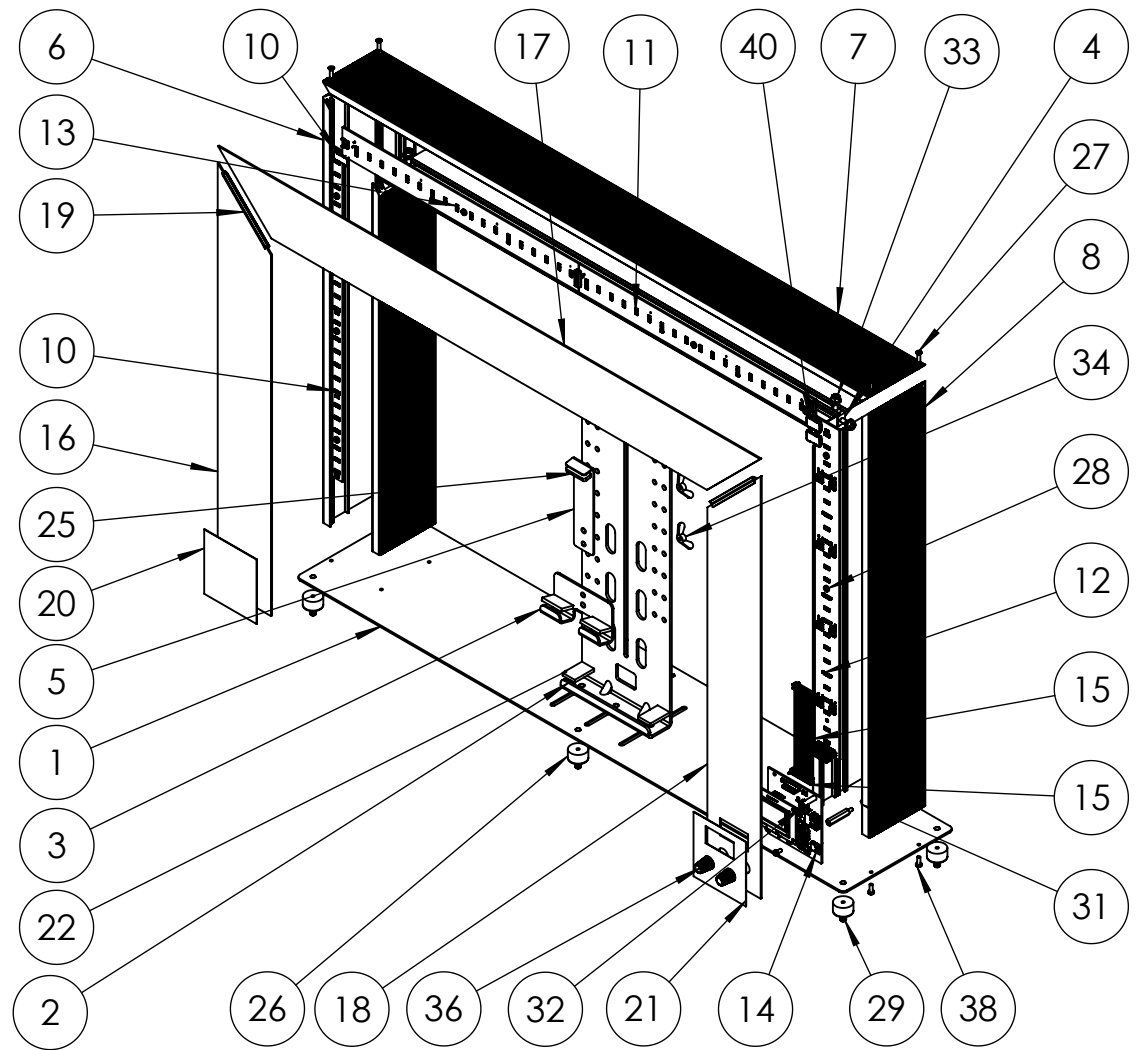

|  |                                     |  |                             |
|--|-------------------------------------|--|-----------------------------|
| <b>Chroma-Q™</b><br><small>BRILLIANT SOLUTIONS</small> |                                     | <small>ALL INFORMATION CONTAINED IN THIS DOCUMENT IS PROPERTY OF CHROMA-Q AND MAY NOT BE REPRODUCED IN WHOLE OR PART WITHOUT PERMISSION OF CHROMA-Q.</small> |                             |
|  |                                     | <small>UNLESS OTHERWISE SPECIFIED ALL DIMENSIONS ARE IN MM [INCHES]</small>  |                             |
| <small>THIRD ANGLE PROJECTION</small><br>              |                                     | <b>TITLE:</b><br><b>SANDI 1622 EXPLODED VIEW</b>   |                             |
| <b>SIZE</b><br>A4                                      | <b>PART NO.</b><br><b>1518-1000</b> | <b>REV</b><br>A  |                             |
| <small>SCALE: 1:20</small>                             |                                     | <small>WEIGHT:</small>   | <small>SHEET 4 OF 4</small> |